

Reel - Model PG461 "Wahoo Special" Parts List

KEY#	PART#	Description
1	(1-461)	Frame (461)
2	(2-461)	Spool
3	(3-461)	Endcap
4	(4-501)	Bearing
4A	(4A-461)	Spool Bearing
4B	(4B-461)	Bridge Bearing
4C	(4C-461)	Drag Sleeve Bearing
4D	(4D-461)	Bearing Retainer
5	(5-502)	Bearing Cap (Left)
6	(6-503)	Bearing Cap (Right)
7	(7-504)	Endcap Screw (2)
8	(8-461)	Eccentric Jack
9	(9-461)	Eccentric
10	(10-461)	Eccentric Spring
11	(11-508)	Eccentric Lever
12	(12-509)	Nylon Washer
13	(13-510)	Eccentric Screw
14	(14-461)	Bridge Plate
14A	(14A-461)	Bridge Shaft
14B	(14B-461)	Bridge Washer
14C	(14C-461)	Bridge E Clip
15	(15-461)	Dog
15A	(15A-461)	Dog Cover
15B	(15B-461)	Dog Cover Screw
15C	(15C-461)	Dog Post
15D	(15D-461)	Dog Ratchet
16	(16-513)	Dog Spring
17	(17-461)	Fiber Washer
18	(18-461)	Main Gear
19	(19-461)	Pinion Gear
20	(20-461)	Bridge Screw (6)
22	(22-461)	Metal Drag Washers (3)
23	(23-461)	Fiber Drag Washers (3)
24	(24-461)	Dome Washer
25	(25-461)	Yoke
26	(26-461)	Yoke Spring (2)
26A	(26A-461)	Yoke Post (2)
27	(27-461)	Drag Spacer
28	(28-461)	Star
29	(29-461)	461 Handle
30	(30-461)	Handle Screw
30A	(30A-461)	Handle Screw Retainer
31	(31-528)	Handle Lock Screw
32	(32-529)	541 Lower Clamp Set*
33 *	(33-530)	T-Nut (2)
34 *	(34-531)	Lower Clamp Stud (2)
35 *	(35-532)	Lower Clamp Hex Nut (2)
36 *	(36-533)	Clamp Washer (2)
37	(37-534)	Upper Clamp
38	(38-535)	Upper Clamp Screws (4)
39 *	(39-538)	Lower Clamp
40	(40-461)	Tension Washer
42	(42-542)	Clicker Spring
42A	(42A-542)	Clicker Spring Washer
42B	(42B-542)	Clicker Spring Screw
43	(43-543)	Clicker Knob
43A	(43A-543)	Clicker Knob Washer
43B	(43B-543)	Clicker Tongue
43C	(43C-543)	Clicker Tongue Washer
43D	(43D-543)	Clicker Knob E Clip

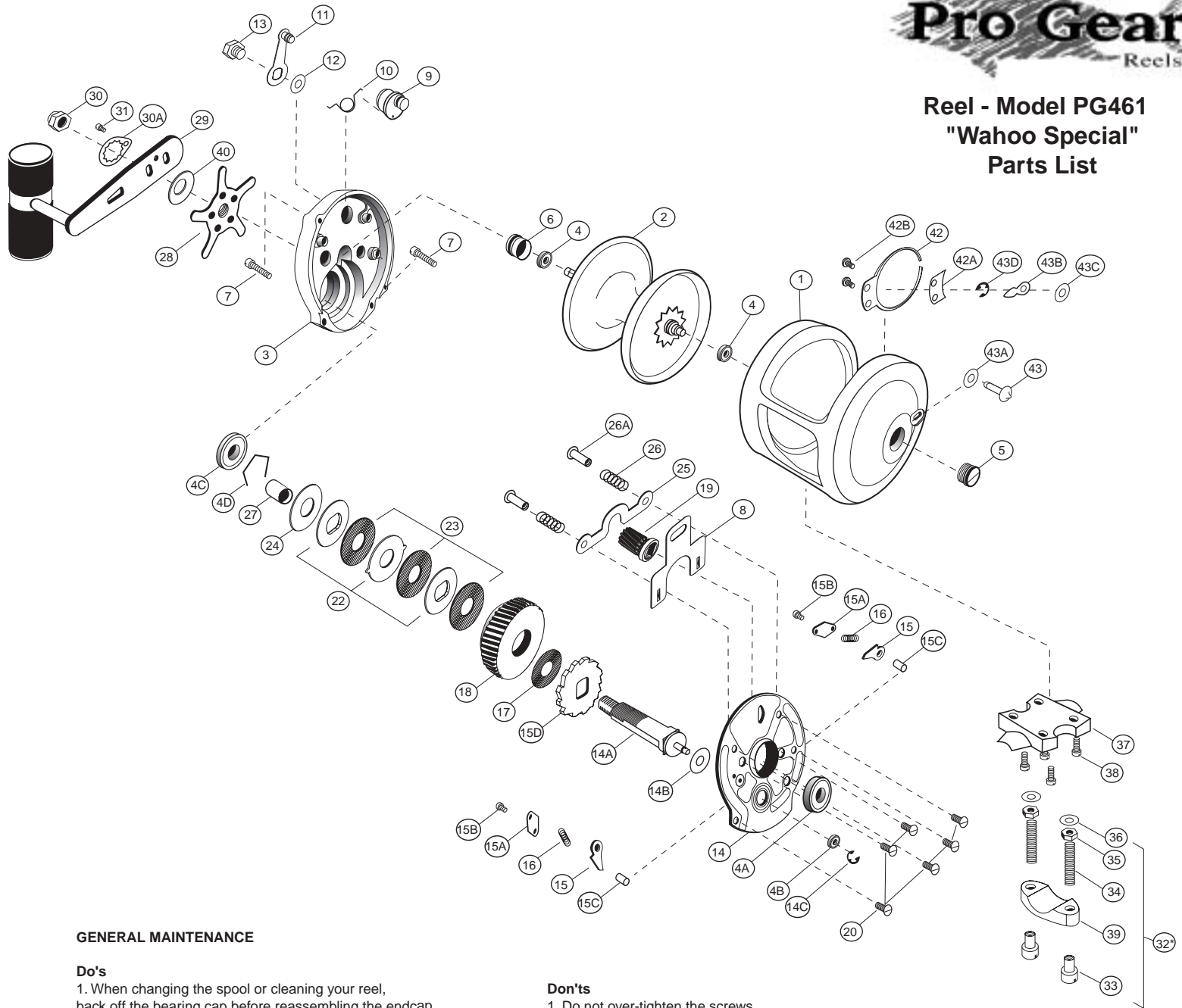

GENERAL MAINTENANCE

Do's

1. When changing the spool or cleaning your reel, back off the bearing cap before reassembling the endcap.
2. After cleaning your reel, lightly oil all moving parts.
3. Lightly lube between the frame and endcap before reinstalling.
4. If necessary, lightly oil the bearings with a recommended bearing oil.

Don'ts

1. Do not over-tighten the screws.
2. Do not immerse in water when cleaning.
3. Do not over lubricate.
4. Do not over tighten the bearing cap.

Please see your authorized Pro Gear® warranty station for complete service or parts.